

## Approvals:



CE



2yr Guarantee



Zone 1



Zone 2



Meet the new generation of Xpelair **Slimline SL100** and **SL150** fans, with wall hugging wafer-thin grilles designed for modern living.

## Key features

**Type:** Axial extract fan with wafer thin grille

**Application:** Domestic bathrooms, shower rooms and toilets

**Control options:** Pull cord, timer & humidistat

**Legislation:** Conforms to Building Regulations

**Hole size:** 100mm (SL100) 150mm (SL150)

## The range

Meet the new generation of Xpelair **Slimline SL100** and **SL150** fans, with wall hugging wafer-thin grilles designed for modern living. They are white in colour and are ideal for domestic bathrooms, shower rooms, toilets and other small rooms. With an internal projection of only 15mm, the **Slimline** unit is one of the lowest profile bathroom fans available. For bigger bathroom **Slimline** is also available in a 150mm size offering performance and style.

For rooms with no opening window **Slimline SL100** is available with a built-in overrun timer. Humidistat models are available for shower rooms and heavily used bathroom applications. Ordering is straight-forward: simply select the size and control option required, then add the appropriate window or wall kit.

But the **Slimline** range doesn't just have a pretty face, installation is simple too. All **Slimline** models have two adjustable QuickClamp fixings which make traditional wall plug and screw fixings a thing of the past.

The IPX4 rated units fully meet the requirements of the Building Regulations for bathrooms, toilets and kitchens and the IP requirements for zone 1 and zone 2 as defined by the IEE Wiring Regulations (16th Edition) BS7671:2001. All models are suitable for a supply voltage of 220-240V 50Hz and ambient temperatures up to 40°C.

## Models

### SL100

#### Ref. 91225AW:

- Single speed axial fan
- Operated by remote switch (in a bathroom normally a separate pullcord or lighting circuit)
- Colour: White

### SL100P

#### Ref. 91226AW:

- Single speed axial fan with pullcord
- Operated by integral On/Off pullcord switch
- Colour: White

### SL100T

#### Ref. 91227AW:

- Single speed axial fan with timer
- Timer triggered by remote switch-usually the lighting circuit
- Timer variable from 3-15mins
- Colour: White

### SL100HT

#### Ref. 91228AW:

- Single speed axial fan with humidistat and overrun timer
- Built in adjustable humidistat
- Integrated overrun timer eliminates nuisance tripping
- Timer variable from 45s-15mins
- Colour: White

### SL150

#### Ref. 91229AW:

- Single speed axial fan
- Operated by a remote switch, usually a lighting circuit
- Colour: White

### SL150P

#### Ref. 91230AW:

- Single speed axial fan with pullcord
- Operated by integral On/Off pullcord switch
- Colour: White

### SL150HT

#### Ref. 91231AW:

- Single speed axial fan with humidistat and overrun timer
- Built in adjustable humidistat
- Integrated overrun timer eliminates nuisance tripping

- Timer variable from 45s-15mins
- Colour: White

## Controllers

### Passive Infrared Sensor XPIRA

#### Ref. 21871AA

- Activates fan via body movement
- Ideal for infrequently used public spaces
- Built in timer to prevent nuisance tripping

### Remote Time Delay Unit DT20B

#### Ref. 21850AW

- User adjustable run-on timer (2-20mins)

## Technical specification

The unit is to be supplied from the Xpelair SL100 & SL150 range by Applied Energy Products Ltd, Morley Way, Peterborough PE2 9JJ  
Tel. +44 (0)1733 456789

## Model / Ref

SL100 / 91225AW  
SL100P / 91226AW  
SL100T / 91227AW  
SL100HT / 91228AW  
SL150 / 91229AW  
SL150P / 91230AW  
SL150HT / 91231AW

- The unit shall be designed for wall, ceiling, shaft (or window mounting in glass up to 6mm thick) using the kit provided
- Shall be designed so that the front grille thickness is no more than 15mm
- The fan housing shall be moulded in high gloss white ABS and be of modern design with finger guarding for additional safety protection
- The motor shall be lubricated for life with built in safety thermal overload protection
- The unit shall be rated at IPX4 and a double insulated appliance
- In addition it shall conform to Building Regulations for use in toilets and bathrooms
- P models shall include integral pullcord
- T models shall include integral timer control (3 - 15mins)
- HT models shall include integral humidity control (45 - 99%RH) and timer control
- Dimensions shall be W x H x D:  
SL100 - 140mm x 140mm x 98mm (front cover 10mm)  
SL150 - 190mm x 190mm x 112mm (front cover 15mm)

## Product variations

	SL100	SL100P	SL100T	SL100HT	SL150	SL150P	SL150T	SL150HT	SL150HP
Reference number	91225AW	91226AW	91227AW	91228AW	91229AW	91230AW	92361AW	91231AW	91496AW
Remote switch (supplied)	yes	no	yes	no	yes	no	Yes	no	no
Integral pullcord	no	yes	no	no	no	yes	No	no	yes
Integral timer (adjustable up to 15 mins)	no	no	yes	yes	no	no	Yes	yes	yes
Integral humidity sensor (45-99% RH)	no	no	no	yes	no	no	No	yes	yes
Extract performance (FID, m <sup>3</sup> /h)	67	67	67	67	180	180	218	180	218
Extract performance (FID, l/s)	18.5	18.5	18.5	18.5	50	50	60	50	60
Sound pressure level (dB(A)@3m)	39	39	39	39	43	43	43	43	43
Electrical power rating (W)	15	15	15	15	25	25	35	25	37
Weight (kg)	0.6	0.6	0.6	0.6	0.9	0.9	0.9	0.9	0.4
IP rating	IPX4	IPX4	IPX4	IPX4	IPX4	IPX4	IPX4	IPX4	IPX4
Guarantee (years)	2	2	2	2	2	2	2	2	2

## SL100:

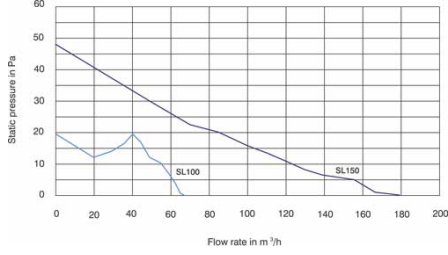

Performance:

### Slimline 100/150

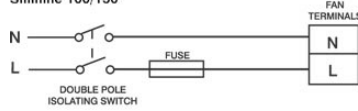

### Slimline 100P/150P

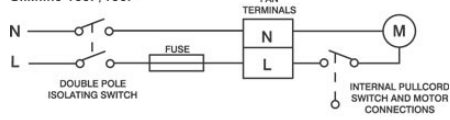

### Slimline 100T/HT/150HT

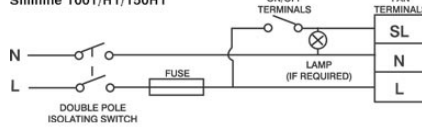

Wiring:



**Wall mounting**  
Hole diameter  
= 100mm (SL100)  
= 150mm (SL150)

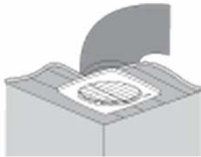

**Ceiling mounting**  
Hole diameter  
= 100mm (SL100)  
= 150mm (SL150)

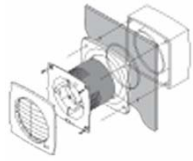

**Window mounting**  
Hole diameter  
= 100mm (SL100)  
= 150mm (SL150)

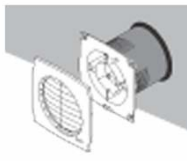

**Ducted applications**  
Hole diameter  
= 100mm (SL100)  
= 150mm (SL150)  
Duct diameter  
= 100mm (SL100)  
= 150mm (SL150)

### SL100 Range

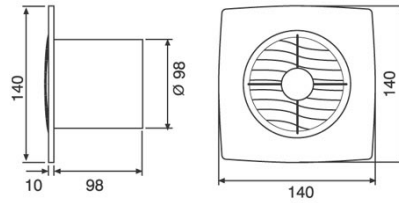

### SL150 Range

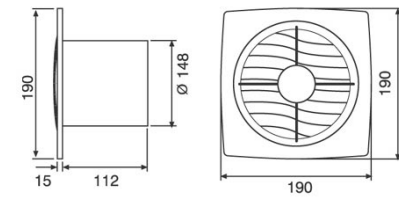

Installation:

Dimensions: All dimensions in mm